

PIN	L	L1	L2	P2
9	5.41	4.96	4.25	3.20
10	5.81	5.36	4.65	3.60

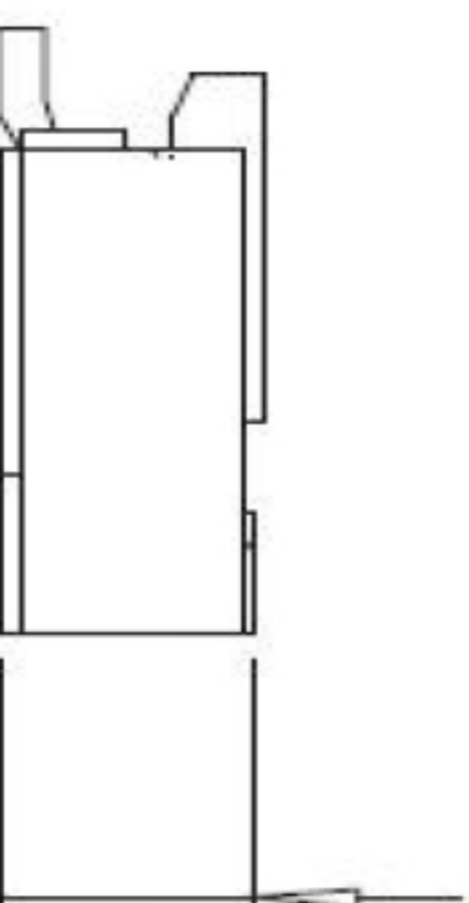

0.90±0.10

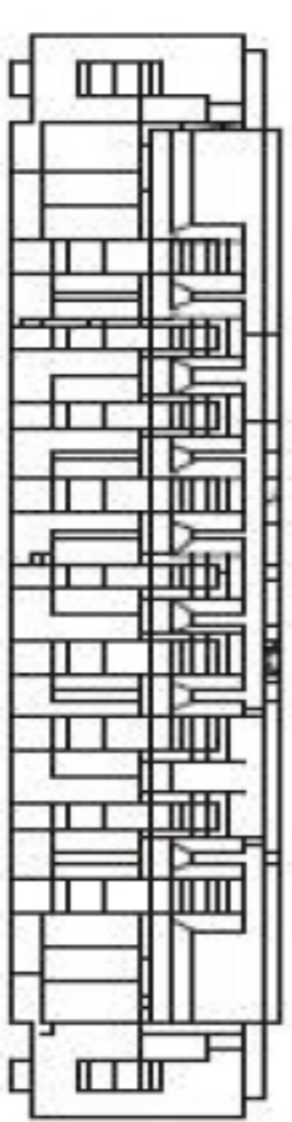
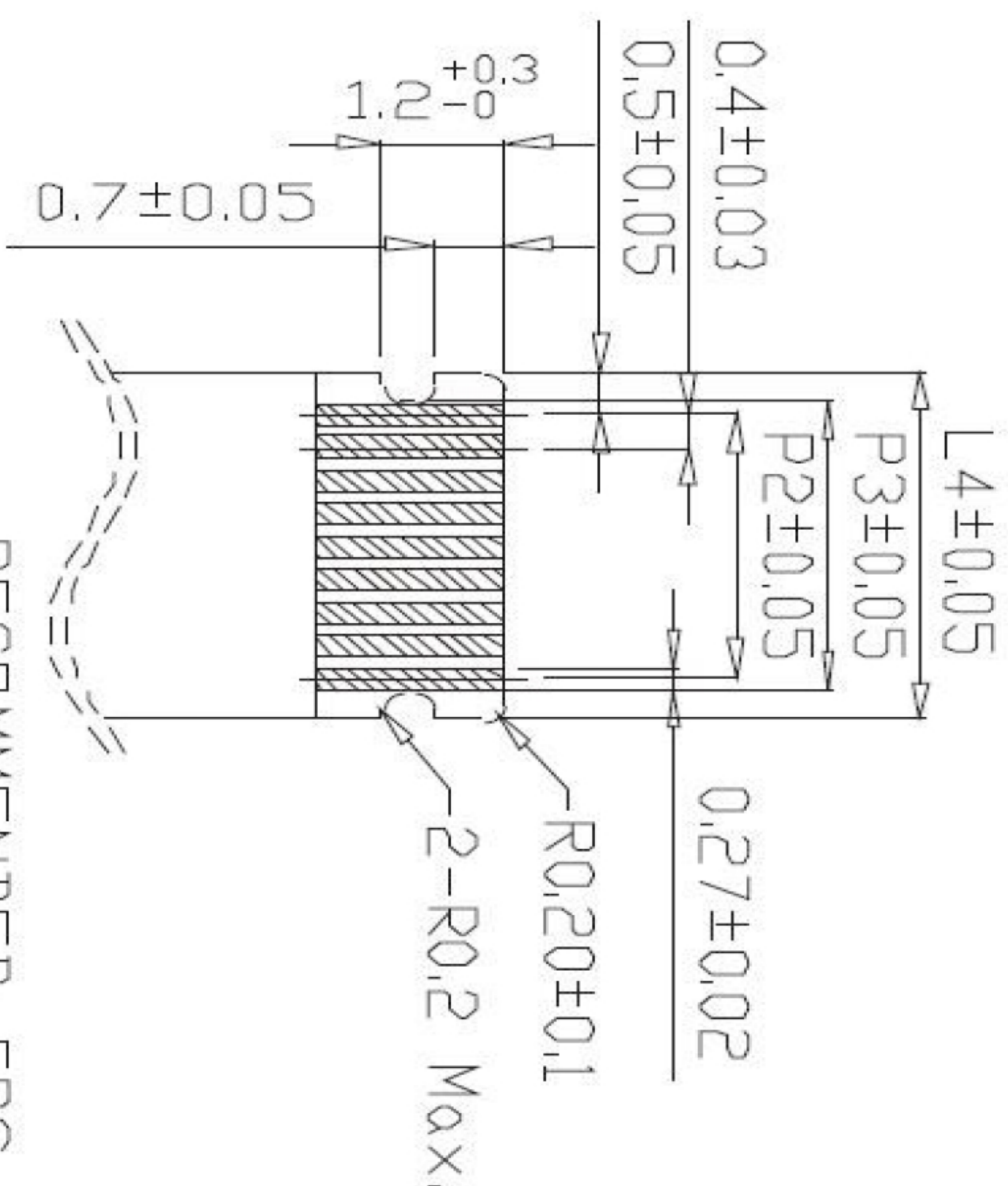

PIN	L3	L4	P2	P3
9	5.40	4.20	3.20	3.50
10	5.80	4.60	3.60	3.90

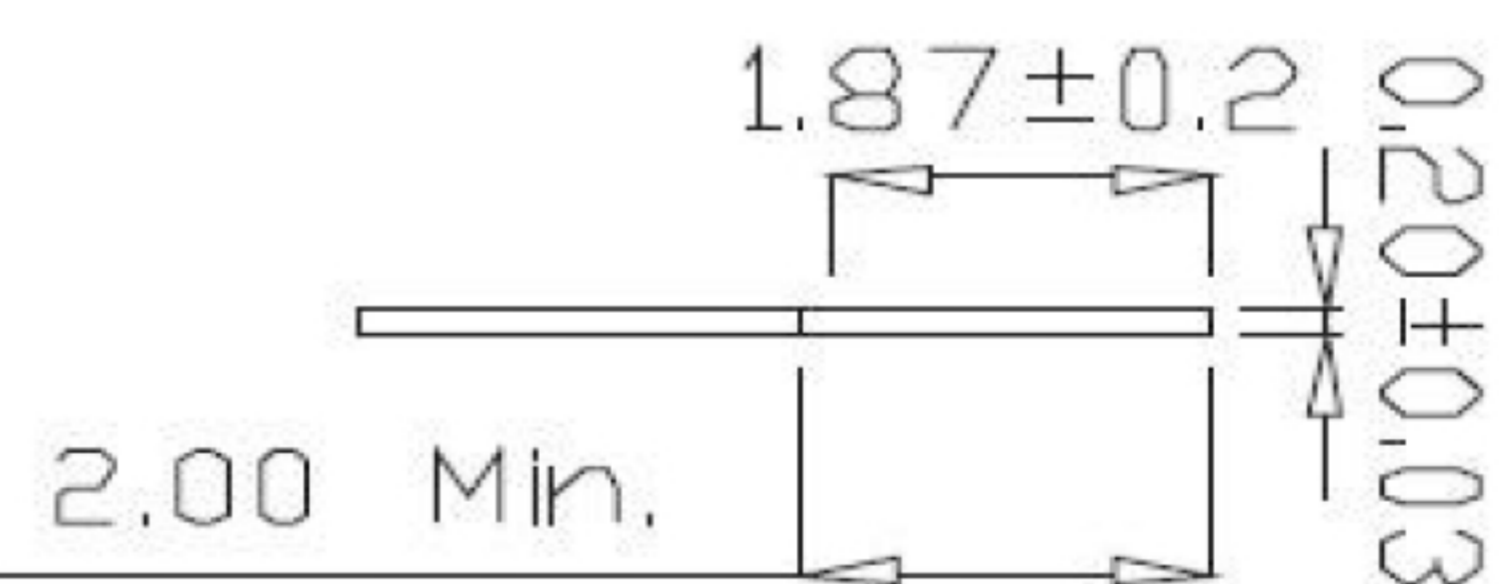
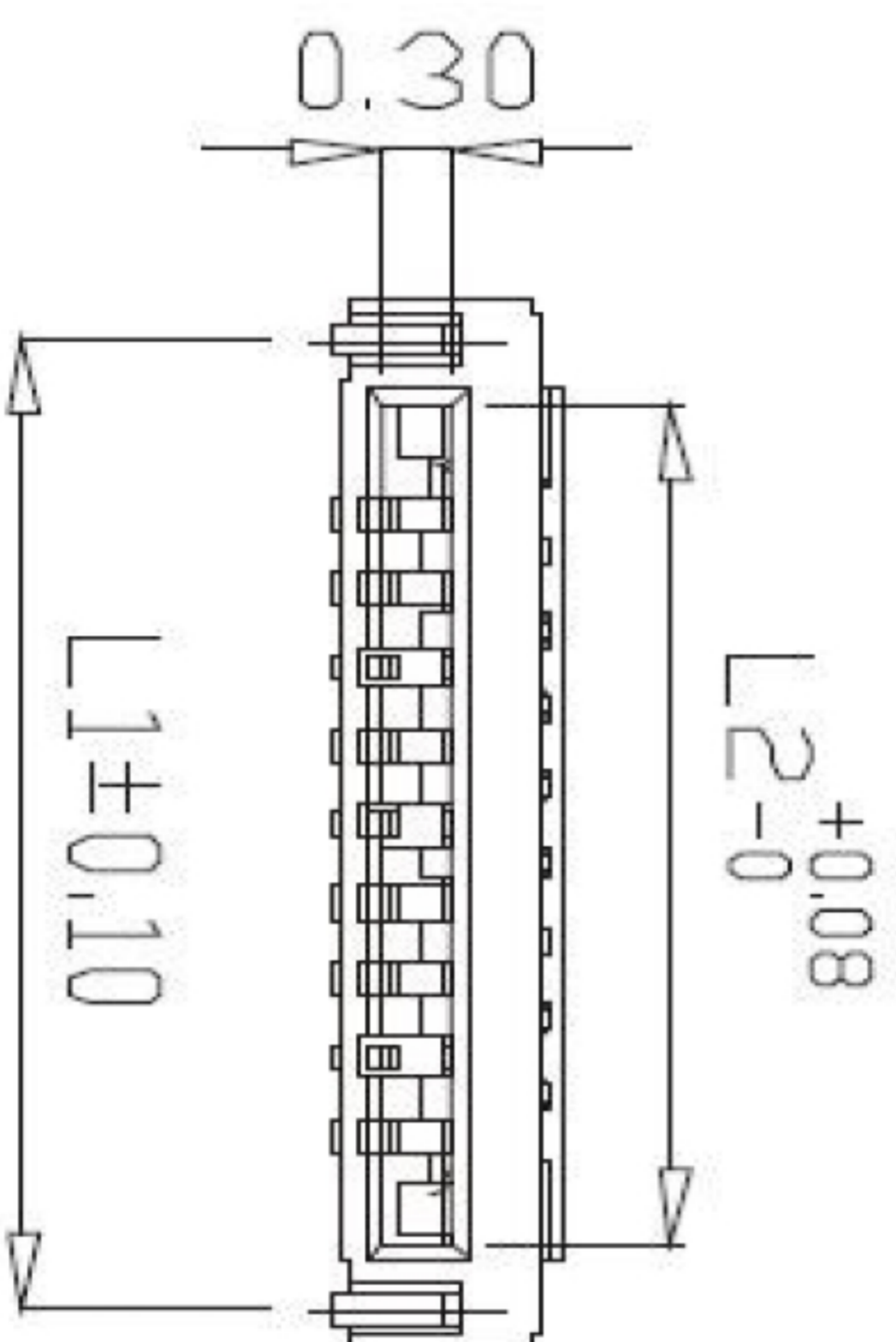

**PERFORMANCE**

Electrical Rating: AC/DC 40V 0.4A  
 額定電壓電流  
 Insulation Resistance: 500MΩ min.  
 絕緣阻抗  
 Withstanding Voltage: 150V AC/minute  
 耐電壓  
 Temperature Range: -25°C~+85°C  
 適用溫度

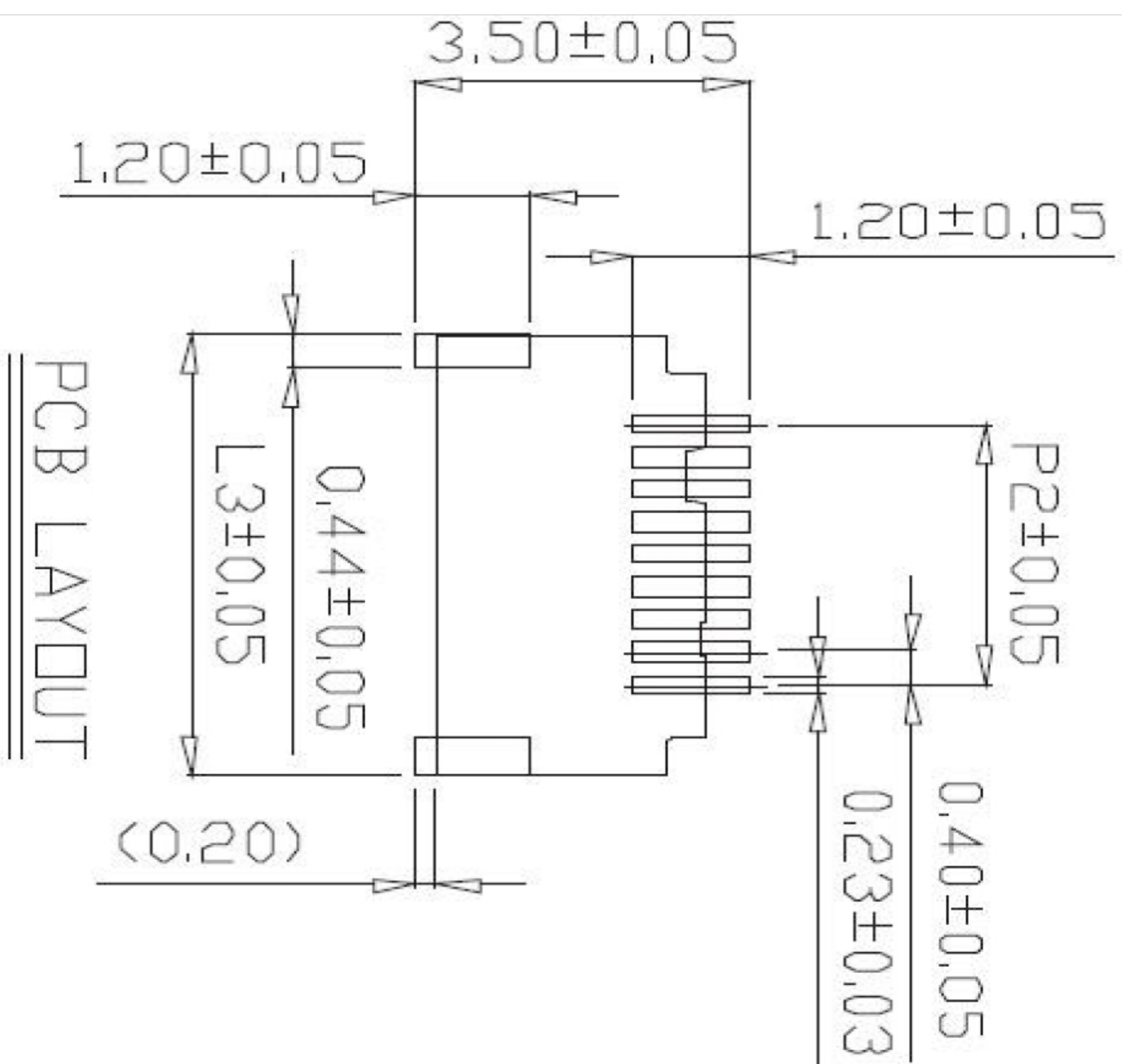

ECN NO.	REV.	DATE.	DESCRIPTION.
	A		NEW
CHANGE.	CHECK.	APPRO.	

APPROVALS		DATE	TITLE:	
DRAWN	ZHIWEI.CHEN	2015.07.07	PART NO.	GP04-WSHA-XXP-A-X01
CHECKED			UNIT: mm	SCALE: 1:1
APPROVALS			DRAWING NO.	PROJ: 1 OF 1
TOLERANCES ARE		30~以上 ±0.30	ANGLE	±2°
		10~30 ±0.20		
		5~10 ±0.15		
		~5 ±0.10		



深圳市联丰电子有限公司  
 SHENZHEN LINFENG ELECTRONIC CO.,LTD